



Serving  
Alachua • Bradford  
Columbia • Dixie • Gilchrist  
Hamilton • Lafayette • Madison  
Suwannee • Taylor • Union Counties

---

2009 NW 87th Place, Gainesville, FL 32653 -1803 • 352.955.2200

# MEETING NOTICE

## REGIONAL PLANNING COMMITTEE

There will be a meeting of the Regional Planning Committee of the North Central Florida Regional Planning Council on **July 23, 2015**. The meeting will be held at the **Holiday Inn Hotel & Suites, 213 SW Commerce Boulevard, Lake City**, beginning at **6:30 p.m.**

(Location Map on Back)

Dedicated to improving the quality of life of the Region's citizens,  
by coordinating growth management, protecting regional resources,  
promoting economic development and providing technical services to local governments.

# Holiday Inn Hotel & Suites

213 SW Commerce Blvd  
Lake City, Florida 32025

Directions: From the intersection of Interstate 75 and U.S. Highway 90 (exit 427) in the City of Lake City turn, East onto U.S. Highway 90, travel approximately 450 feet to SW Commerce Blvd, turn right (South) onto SW Commerce Blvd, travel approximately 720 feet and the Holiday Inn Hotel & Suites is on the left.

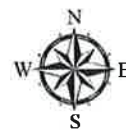
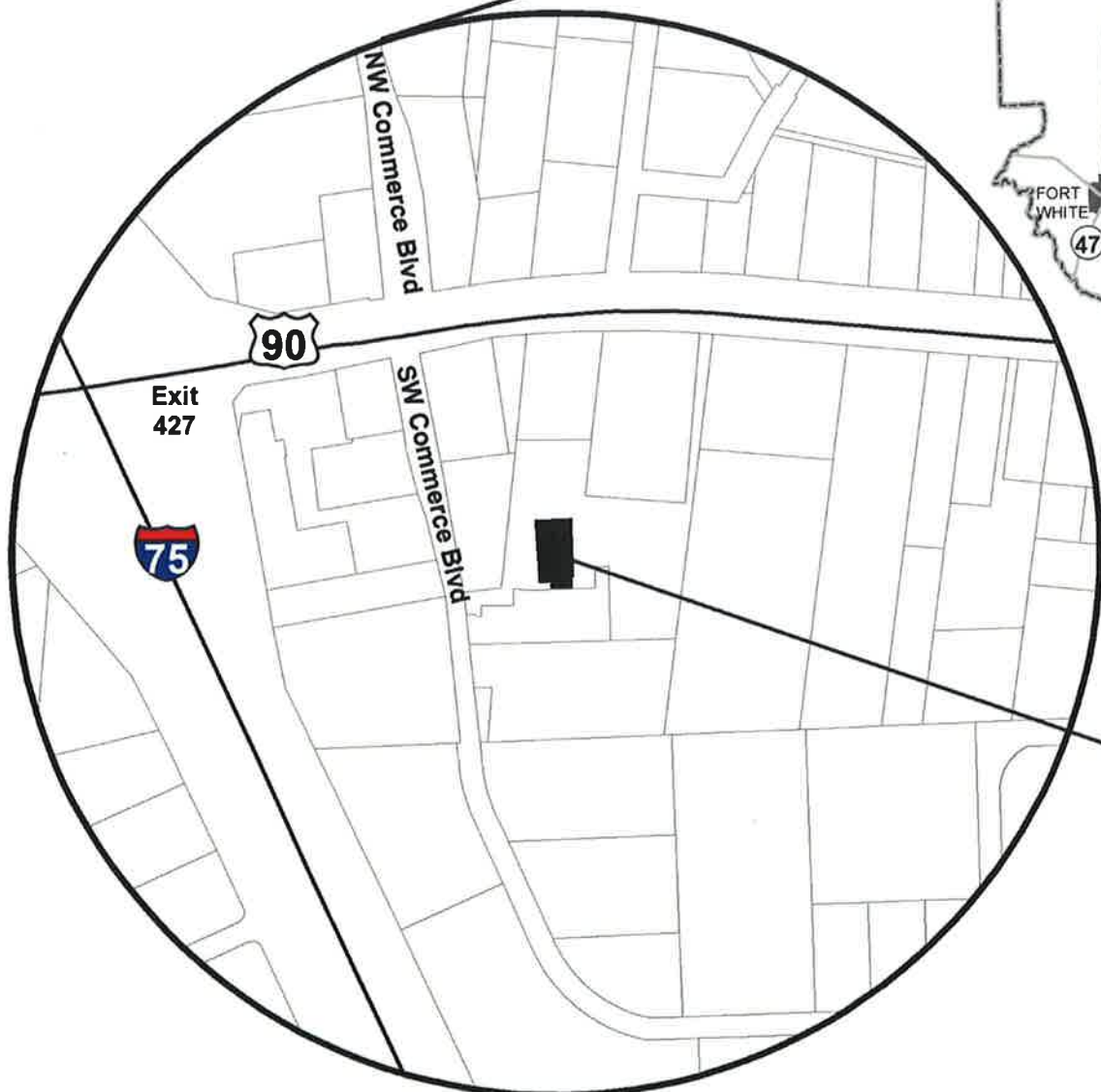

1 inch = 500 feet

Holiday Inn  
Hotel & Suites





Serving  
Alachua • Bradford  
Columbia • Dixie • Gilchrist  
Hamilton • Lafayette • Madison  
Suwannee • Taylor • Union Counties

---

2009 NW 87th Place, Gainesville, FL 32653 - 1603 • 352.955.2200

## AGENDA

### REGIONAL PLANNING COMMITTEE

Holiday Inn Hotel & Suites  
Lake City, Florida

July 23, 2015  
6:30 p.m.

**PAGE NO.**

- |     |                                                 |          |
|-----|-------------------------------------------------|----------|
| I.  | APPROVAL OF THE JUNE 25, 2015 MEETING MINUTES   | <b>5</b> |
| II. | REGIONALLY SIGNIFICANT FACILITIES AND RESOURCES | <b>7</b> |



NORTH CENTRAL FLORIDA REGIONAL PLANNING COUNCIL

REGIONAL PLANNING COMMITTEE

MINUTES

Holiday Inn Hotel & Suites  
Lake City, Florida

June 25, 2015  
6:30 p.m.

MEMBERS PRESENT

Beth Burnam, Vice-Chair (via telephone)  
Donnie Hamlin  
James Montgomery  
Randy Wells, Chair  
Robert Wilford

MEMBERS ABSENT

Chuck Chestnut, IV  
Lorene Thomas  
Mike Williams  
Stephen Witt

STAFF PRESENT

Steven Dopp

Chair Wells called the meeting to order at 6:30 p.m.

I. APPROVAL OF THE MAY 28, 2015 MEETING MINUTES

**ACTION:** It was moved by Mr. Montgomery and seconded by Commissioner Hamlin to approve the May 28, 2015 Committee minutes as circulated. The motion carried unanimously.

II. REGIONAL TRANSPORTATION ELEMENT

Mr. Dopp presented the staff evaluation of the Regional Transportation Element. The Committee reviewed and discussed the staff evaluation. The Committee agreed by consensus to withhold approval of the evaluation until completion of the review of all elements of the regional plan.

The meeting adjourned at 6:47 p.m.

\_\_\_\_\_  
Randy Wells, Chair

7/23/15  
Date



## **REGIONALLY SIGNIFICANT FACILITIES AND RESOURCES**

The list of regionally significant facilities and resources contained in the regional plan recognizes those regionally significant facilities and resources not identified in either the Affordable Housing, Economic Development, Emergency Preparedness, Natural Resources of Regional Significance or Regional Transportation Elements. The regional plan does not contain a map of these facilities and resources. Rather, a listing is included, base on type of facility and resource. Types of regionally significant facilities and resources consist of cultural facilities, educational institutions, electric power facilities, Florida greenways and trails, historical facilities, hospitals, landfills, natural gas transmission lines and state prisons.

In May 2015, Governor Rick Scott signed into law Senate Bill 1216 which eliminated the Withlacoochee Regional Planning Council and transferred its member counties to adjoining regional planning councils. Levy County and Marion County are now part of the north central Florida region. As part of the legislation, the Strategic Regional Policy Plan for the Withlacoochee Region remains in place for Levy and Marion Counties until such time as the two counties are incorporated into the North Central Florida Strategic Regional Policy Plan.

It is recommended that regionally significant facilities and resources identified in the Withlacoochee Strategic Regional Policy Plan which are located in either Levy or Marion Counties be considered for inclusion in the Regionally Significant Facilities and Resources chapter of the North Central Florida Strategic Regional Policy Plan.







# Chapter VI

## Regionally Significant Facilities and Resources

Adopted May 23, 1996, Amended August 28, 1997, February 27, 2003 and October 27, 2011



THIS PAGE LEFT BLANK INTENTIONALLY

Adopted May 23, 1996, Amended August 28, 1997, February 27, 2003 and October 27, 2011

**Chapter VI - Regionally Significant Facilities and Resources**



## Chapter VI: Regionally Significant Facilities and Resources

Regionally Significant Facilities and Resources are those facilities and resources identified by the Council as being of regional importance and meets one or more of the following criteria: (1) its uniqueness, function, benefit, service delivery area, or importance is identified as being of regional concern; (2) a facility or resource that requires the participation or involvement of two or more governmental entities to ensure proper and efficient management; or (3) a facility or resource that meets either criteria in 1 or 2 above and is defined to be of state or regional concern or importance in state or federal laws or rules of state or regional agencies adopted pursuant to Chapter 120, Florida Statutes.<sup>1</sup>

Facilities recognized by the North Central Florida Strategic Regional Policy Plan as regionally significant facilities and resources not addressed elsewhere are comprised of cultural facilities, educational institutions, electric power generation stations, hospitals, landfills, military facilities, and state prisons.

Cultural Facilities recognized as regional facilities are those which are either owned or funded (at least in part) by the state or provide cultural opportunities to residents of multiple local jurisdictions.

Educational institutions recognized as regional facilities are those which provide either two or four year college degrees or technical training to residents of multiple local jurisdictions.

Electrical power facilities recognized as regional facilities are those facilities which provide electrical power to multiple local government jurisdictions.

Florida Greenways recognized as regional facilities are those greenways which have been formally recognized as such by the Florida Greenways Commission.

Hospitals recognized as regional facilities are those facilities which provide medical services to residents of multiple local government jurisdictions.

Landfills recognized as regional facilities are those facilities which provide solid waste disposal services to multiple local government jurisdictions.

State prisons are recognized as regional facilities as they hold prisoners whose place of residence is from outside the region. They also represent a significant source of employment for north central Florida residents. Since the majority of prisoners housed in north central Florida prisons are from outside the region, state prisons are considered to be a basic industry for north central Florida.

<sup>1</sup>North central Florida regionally significant facilities and resources, as defined in Rule 27E.005, Florida Administrative Code, consist of Regionally Significant Emergency Preparedness Facilities identified in Table 3.2, Natural Resources of Regional Significance identified in Table 4.1, Regionally Significant Transportation Facilities identified in Table 5.9, and Regionally Significant Facilities and Resources, identified in Section VI.



## **A. Cultural Facilities**

Center for Performing Arts  
Florida State Museum  
Florida Trail  
Forest Capital Museum  
Hippodrome State Theater  
Marjorie Kinnan Rawlings State Historical Site  
Samuel P. Harn Art Museum  
Stephen Foster State Folk Culture Center

## **B. Educational Institutions**

Bradford-Union County Vocational Technical Center  
Lake City Community College  
North Florida Junior College  
Santa Fe College  
Suwannee-Hamilton Vocational Technical Center  
Taylor Technical Institute  
University of Florida

## **C. Electric Power Facilities**

Electric Power Generating Stations  
Electric Transmission Lines of 500 KVA  
Electric Transmission Lines of Lesser Voltage That Serve Multi-County Jurisdictions  
Electric Substations to Support Above-Referenced Transmission Line Facilities

## **D. Florida Greenways**

Aucilla River (Madison and Taylor Counties)  
Big Bend Saltwater Paddling Trail (Dixie and Taylor Counties)  
Florida National Scenic Trail (Columbia County)  
Pinhook Swamp Purchase Unit (Columbia County)  
Devils Millhopper State Geological Park (Alachua County)  
Dudley Farm Historic State Park (Alachua County)  
Econfina River State Park (Taylor County)  
Fanning Springs State Park (Gilchrist County)  
Ichetucknee Springs State Park (Columbia and Suwannee Counties)  
Nature Coast Trail State Park (Gilchrist and Dixie Counties)  
O'Leno State Park (Columbia County)  
Peacock Springs State Park (Columbia County)  
River Rise Preserve State Park (Columbia County)  
Stephen Foster State Culture Center Segment (Hamilton County)  
Suwannee River State Park (Hamilton, Madison and Suwannee Counties)  
Suwannee River State Park Segment (Suwannee County)  
Troy Springs State Park (Suwannee County)  
Withlacoochee River (North) (Hamilton and Madison Counties)

Adopted May 23, 1996, Amended August 28, 1997, February 27, 2003 and October 27, 2011



## **E. Historical Facilities**

All districts, buildings, and sites listed in the National Register of Historic Places  
All pre-historic sites listed in the Florida Master Site File

## **F. Hospitals**

North Florida Regional Medical Center, Gainesville  
Shands Hospitals in Alachua County  
Veterans Administration Hospital, Gainesville  
Veterans Administration Hospital, Lake City

## **G. Landfills**

New River Solid Waste Management Association (Baker, Bradford, & Union counties)  
Suwannee Valley Solid Waste Management Association (Dixie, Jefferson, Madison, & Taylor counties)

## **H. Natural Gas Transmission Lines**

Natural Gas Transmission Lines

## **I. Military Facilities**

Camp Blanding

## **J. State Prisons**

Columbia Correctional Institution, Columbia County  
Columbia Correction Institution Annex, Columbia County  
Cross City Correctional Institution, Dixie County  
Florida State Prison, Bradford County  
Florida State Prison, West Unit, Bradford County  
Gainesville Community Correctional Center, Alachua County  
Hamilton Correctional Institution, Hamilton County  
Hamilton Correctional Institution Annex, Hamilton County  
Lake Butler Reception and Medical Center, Union County  
Lake City Community Correctional Facility, Columbia County  
Lancaster Correctional Institution, Gilchrist County  
Lawtey Correctional Institute, Bradford County  
Madison Correctional Institution, Madison County  
Mayo Correctional Institution, Lafayette County  
New River Correctional Institution, Bradford County  
New River "O" Unit, Bradford County  
Reception and Medical Center, Main Unit, Union County  
Reception and Medical Center, West Unit, Union County  
Suwannee Correction Institution, Suwannee County  
Taylor Correction Institution, Taylor County  
Taylor Correction Institution Annex, Taylor County  
Union Correctional Institution, Union County

Adopted May 23, 1996, Amended August 28, 1997, February 27, 2003 and October 27, 2011



THIS PAGE LEFT BLANK INTENTIONALLY